

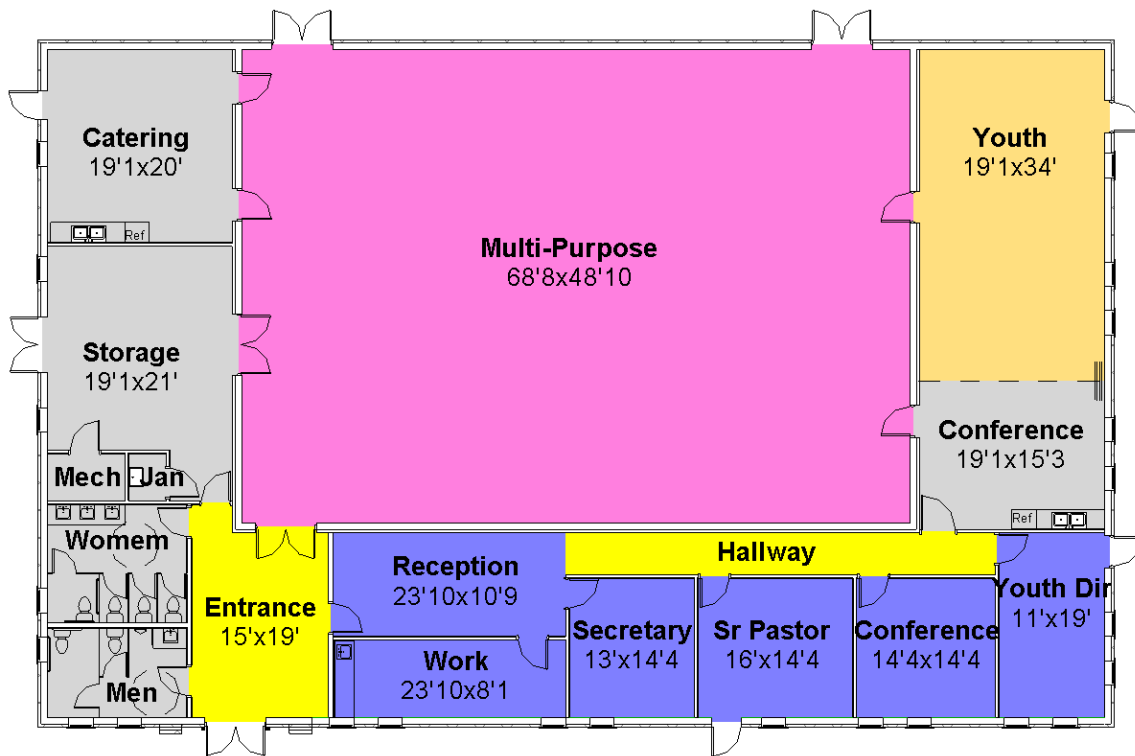

North-Side of the Proposed Building Facing SR 219.



The entrance facing south with church offices running alongside of the current driveway between the church and current office house with redesigned entrance to the proposed building.



The total square footage of the proposed building remains at 7,700 square feet. As noted in the building committee article the youth area and conference room have been shifted, the restroom facilities expanded, and the office area adjusted.

A Towne Meeting on Sunday, September 12 at 7 p.m. in the Social Room is open to all who would like to know more about the proposed building. We will be using PowerPoint for the presentation.

A Congregational Meeting, Sunday, September 19 following the 10:15 a.m. service is called by the Consistory to act up the recommendation of the Building Committee to proceed with the project. The motion will seek approval of the design and the production of drawings for bid. The cost of the design and production of drawings will be \$18,000 to be paid to Bruns Construction Company. Once the drawings for bids are completed they will be let out for bid to other interested contractors. Bids will be requested to be returned 3 weeks following the presentation of the proposal. The Building Committee will review the Bids and select the construction company to proceed.